

TENANT LEGEND		
SUITE	TENANT	SF
2	WEST COAST DENTAL	1624 sf
4	7-ELEVEN	2459 sf
6	BON ACUPUNCTURE	1232 sf
8	PRO NAILS	664 sf
10	HOUSE OF BRIDES	1632 sf
12	JADE HEALTH CENTER	796 sf
14	SHISEN RAMEN	901 sf
16		842 sf
18	WET N' SOAK CLEANERS	842 sf
20		850 sf
22	FANTASTIC SAM'S	1295 sf
24		1873 sf
26	SEI-KO-EN RESTAURANT	968 sf
28	J WOOD MEDICAL SERVICES	665 sf
30		1228 sf
32	SPIRES RESTAURANT	5043 sf

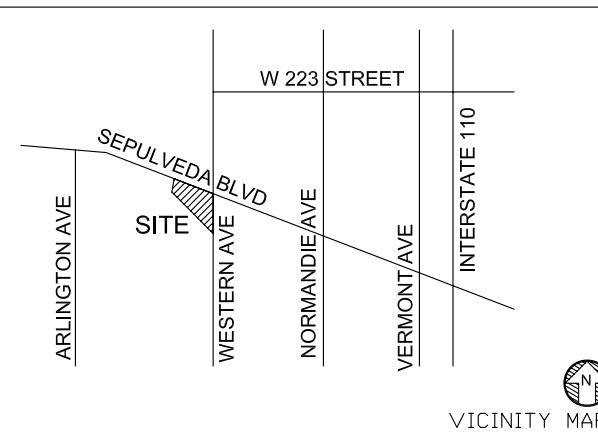
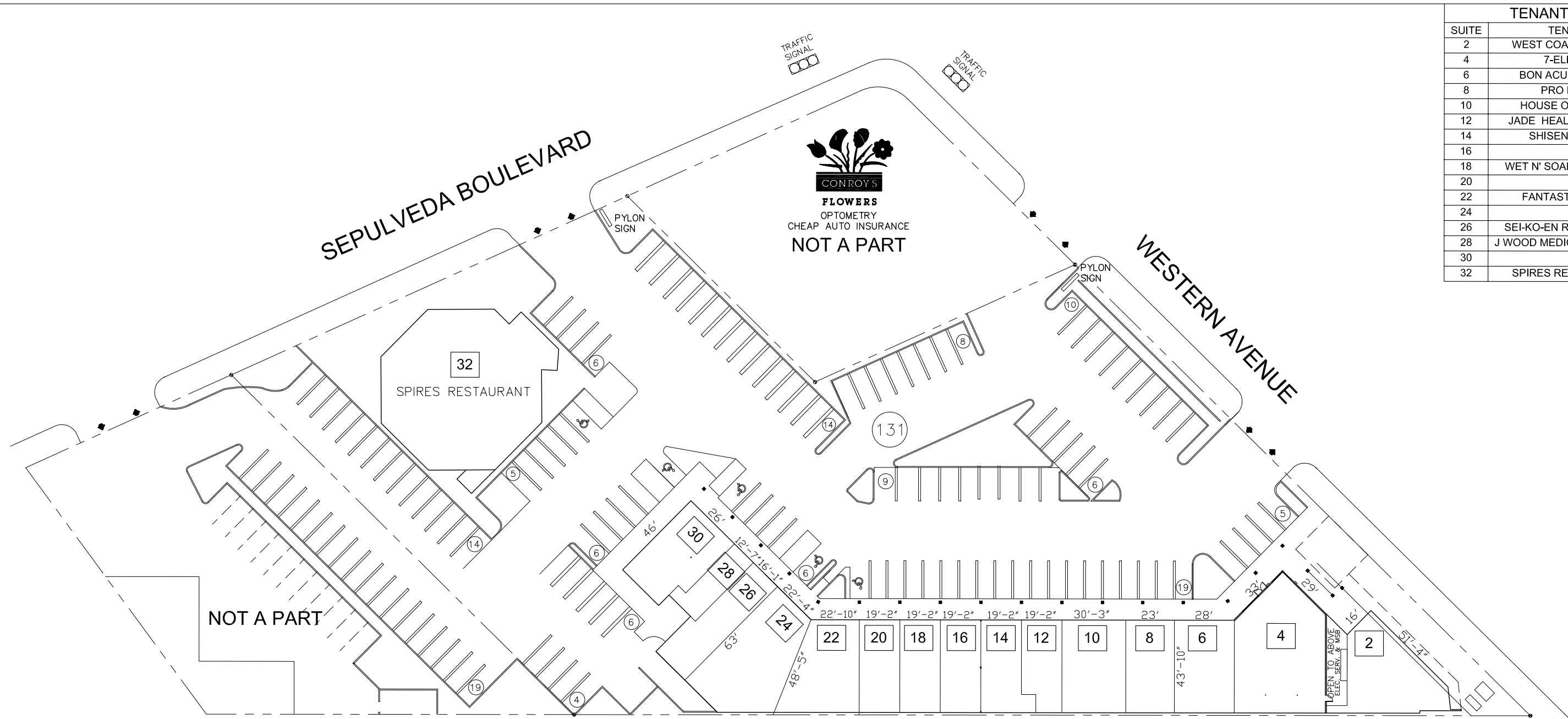

TOTAL BUILDING SF:	22,855 SF		
PARKING PROVIDED:	131 STALLS		
PARKING RATIO:	5.73/1000 SF		
TRAFFIC COUNTS:	114,000 ADT (2005)		
DEMOGRAPHICS	1 MILES	3 MILES	5 MILES
2007 EST. POP.	33,646	223,524	500,028
2012 PROJ. POP.	35,253	237,165	526,634
AVG. HH. INCOME	69,365	70,593	79,707

DISCLAIMER: THIS PLAN IS PROVIDED SUBJECT TO (i) ERRORS AND OMISSIONS IN THE INFORMATION AND (ii) MODIFICATION WITHOUT NOTICE. THE INFORMATION, SPECIFICATIONS, DIMENSIONS AND/OR TABULATIONS SET FORTH IN THIS PLAN HAVE BEEN DERIVED FROM DOCUMENTS BELIEVED TO BE RELIABLE. HOWEVER, THIS PLAN MAY BE INCOMPLETE AND/OR INACCURATE. NO REPRESENTATION OR WARRANTY, EXPRESSED OR IMPLIED AS TO THE ACCURACY OR ADEQUACY REGARDING SUCH INFORMATION IS MADE BY THE OWNER OF THE PROJECT, PROPERTY MANAGER OR ANY OTHER REPECTIVE PARTNERS, DIRECTORS, OFFICERS, EMPLOYEES AND AGENTS. NONE OF THE FOREGOING PARTIES SHALL HAVE ANY LIABILITY FOR SUCH ERRORS, OMMISIONS, INCOMPLETENESS OR INACCURACIES. ANY PERSON OR ENTITY REVIEWING THIS PLAN SHOULD MAKE THEIR OWN INDEPENDENT INVESTIGATION OF THE INFORMATION CONTAINED HEREIN.

**WESTERN TOWN PLAZA**  
 1730 W SEPULVEDA BOULEVARD TORRANCE, CA 90501  
**SITE LEASE PLAN**



SCALE: 0' 25' 50'  
 Oct. 17, 09  
 SHEET 1 OF 1