

SANTA FE SPRINGS MARKETPLACE

NEC NORWALK BLVD. & WASHINGTON BLVD.
WHITTIER, CALIFORNIA 90606



Visit our YouTube channel for vacancy videos: <http://www.youtube.com/wattcoleasing>



STACY AGUIRRE
LEASING MANAGER
310.314.2579
CA DRE LIC. # 01841375
saguirre@wattcompanies.com

KARIN GILBERT
LEASING COORDINATOR
310.314.2466
CA DRE LIC. #01857327
kgilbert@wattcompanies.com

WATT COMPANIES
2716 OCEAN PARK BLVD, STE 3040
SANTA MONICA, CA 90405
310.314.2430
CA DRE LIC. #01228703
www.wattcompanies.com



SANTA FE SPRINGS MARKETPLACE

NEC NORWALK BLVD. & WASHINGTON BLVD.

WHITTIER, CALIFORNIA 90606

AVAILABILITY:

- #11165 - 1,330 sf
- #11203 - 1,330 sf
- #11209 - 1,050 sf
- NNN: \$0.54 psf

PROPERTY HIGHLIGHTS:

- Busy neighborhood center at prime retail intersection
- Close proximity to 605 Freeway
- Flexible lease terms and low start-up costs

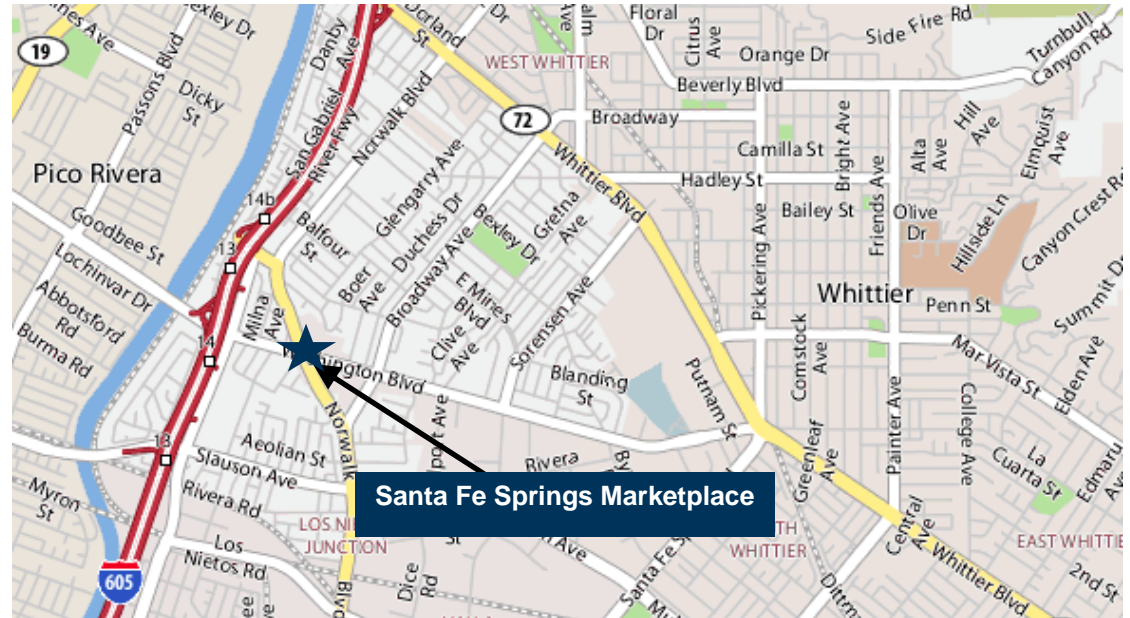

DEMOGRAPHIC HIGHLIGHTS:	1 MILE	3 MILES	5 MILES
POPULATION	25,656	204,659	512,428
AVG HH INCOME	\$71,103	\$72,145	\$72,704
TRAFFIC COUNTS	61,000 ADT	SOURCE: County of LA, 2007	

SANTA FE SPRINGS MARKETPLACE

NEC NORWALK BLVD. & WASHINGTON BLVD.

WHITTIER, CALIFORNIA 90606

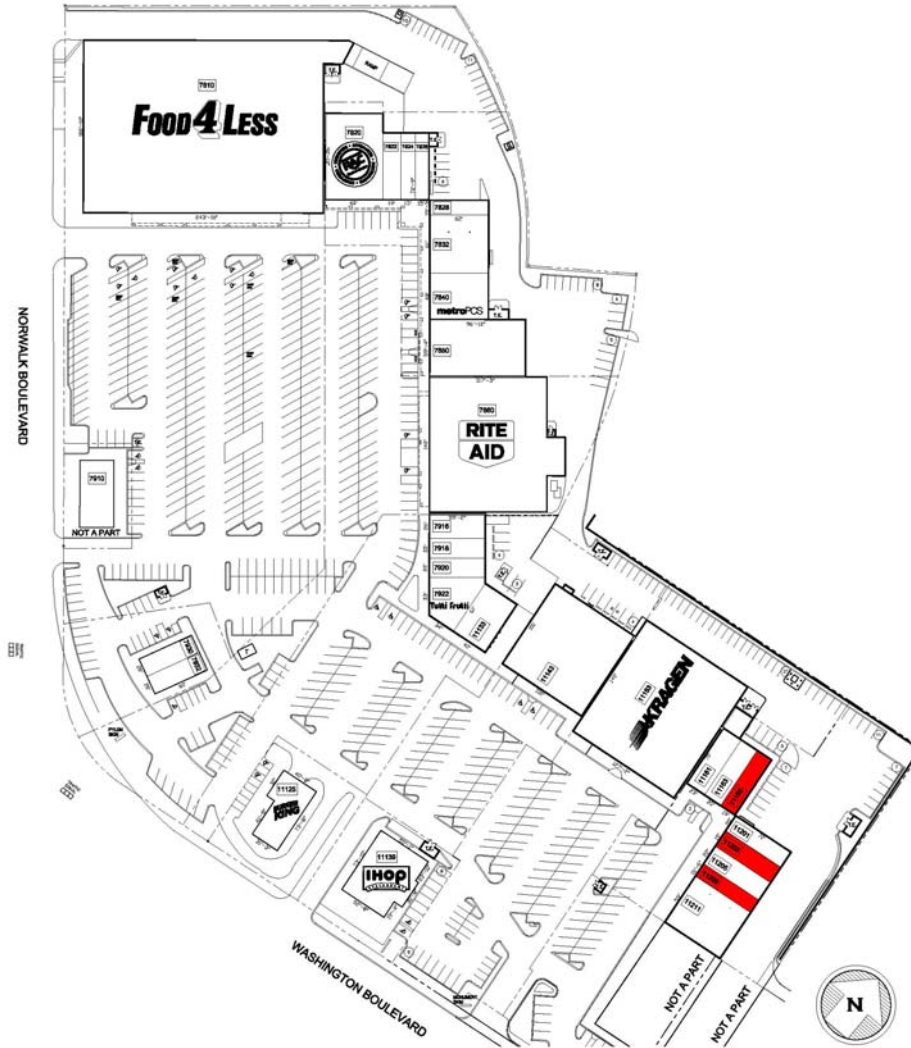

TENANT LEGEND

SUITE	TENANT	SF
7810	FOOD 4 LESS	45,000 sf
7820	RENT-A-CENTER	5400 sf
7822	DRYCLEAN EXPRESS	1400 sf
7824	BOMBAY BEAUTY	1050 sf
7826	J. HEWITT TAX	1050 sf
7828	CITY NAILS II	1054 sf
7832	FASHION Q	3782 sf
7840	METRO PCS	2914 sf
7850	DOLLAR SUPER STORE	5762 sf
7860	RITE AID	17,880 sf
7910	DR. REDDY	2281 sf
7916	CASH 4 YOU	1560 sf
7918	GNC	1260 sf
7920	SUBWAY	1200 sf
7922	TUTTI FRUTTI	1980 sf
7930	HOMESTYLE DONUTS	1200 sf
7932	PAPA JOHN'S	1200 sf
11125	BURGER KING	2784 sf
11133	MUSIC REVOLUTION	2400 sf
11139	IHOP	4500 sf
11143	TOTAL RENAL CARE	10,000 sf
11153	KRAGEN	18,014 sf
11161	WOMEN'S CLINIC	1610 sf
11163	BANGLES	1400 sf
11165	AVAILABLE	1330 sf
11201	MERCURY DIRECT	1353 sf
11203	AVAILABLE	1330 sf
11205	MJO STAFFING	1540 sf
11209	AVAILABLE	1050 sf
11211	FRAZEE PAINT	4063 sf

SANTA FE SPRINGS MARKETPLACE

NEC NORWALK BLVD. & WASHINGTON BLVD.

WHITTIER, CALIFORNIA 90606

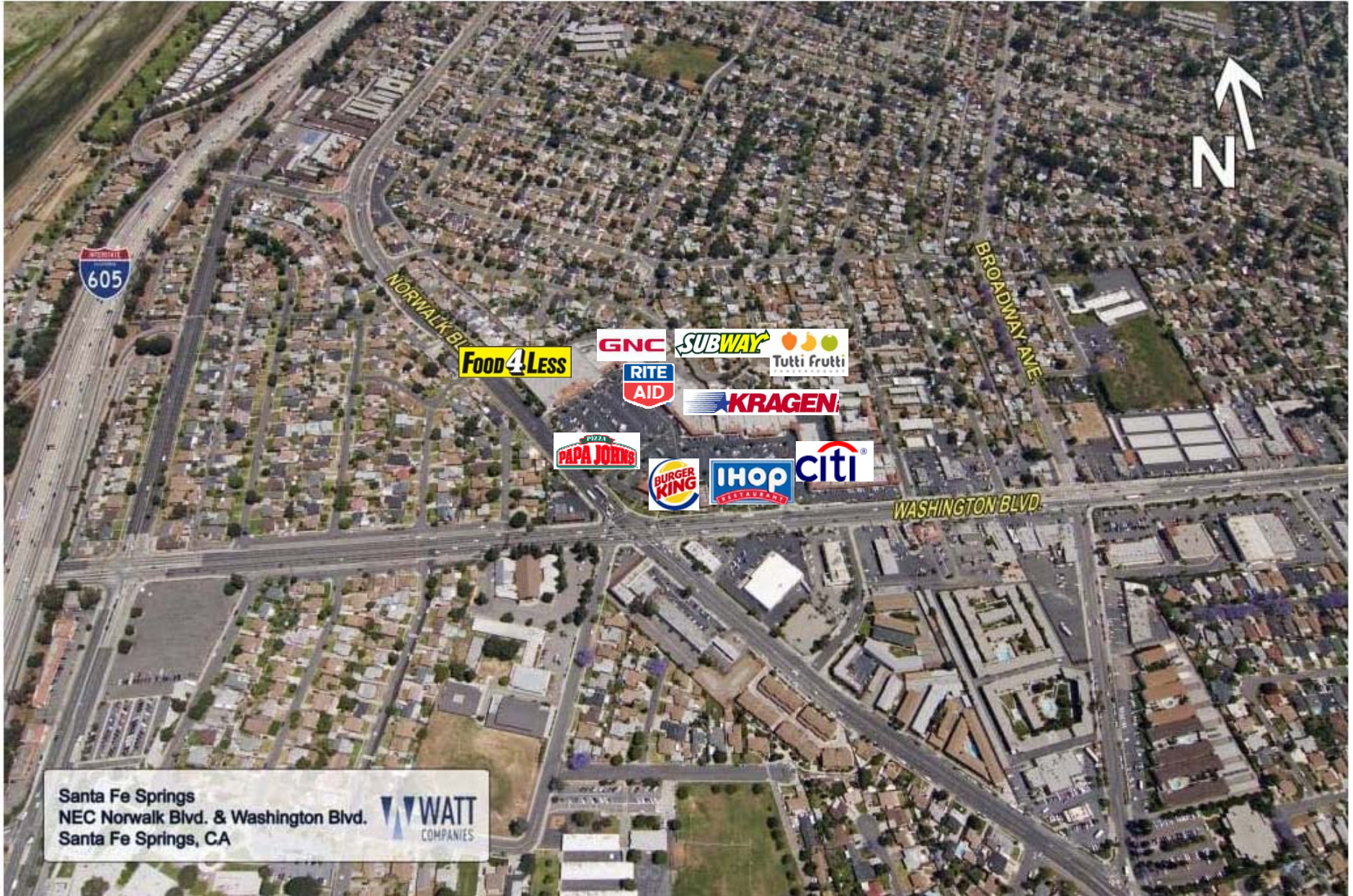

SANTA FE SPRINGS MARKETPLACE

NEC NORWALK BLVD. & WASHINGTON BLVD.

WHITTIER, CALIFORNIA 90606



Santa Fe Springs
NEC Washington Blvd & Norwalk Blvd.
Santa Fe Springs, CA

