

TENANT LEGEND

SUITE	TENANT	SF
2	MARIE CALLENDER'S	9288 sf
6	PET SUPPLY WAREHOUSE	3600 sf
10	CVS	20,000 sf
14	CARPETS & MORE	2000 sf
16	TAN N GO	3300 sf
18	BASKIN ROBBINS	1020 sf
20	CLASSIC CIGAR	900 sf
22	BELLAGIO HAIR	840 sf
24	DR. LA CROIX	840 sf
28	WHOLESOME CHOICE	39,023 sf
32	HI-TEK NAILS	1200 sf
34		1170 sf
36		2470 sf
38	CONTINENTAL CLEANERS	1800 sf
40	ANTONIO'S MEXICAN	900 sf
42	PHOTASIA	1800 sf
44	KAWA ROLLS	1200 sf
46	DR. VASCO, DDS	1200 sf
48	DIVINE THREADING STUDIO	900 sf
50	MALIBU MEDICAL	900 sf
52		1950 sf
54	DELLA'S HAIR	1080 sf
56	ANAHEIM PET CLINIC	1620 sf
60		6450 sf
66	MILEPOST TRAINS	3500 sf
67		3500 sf

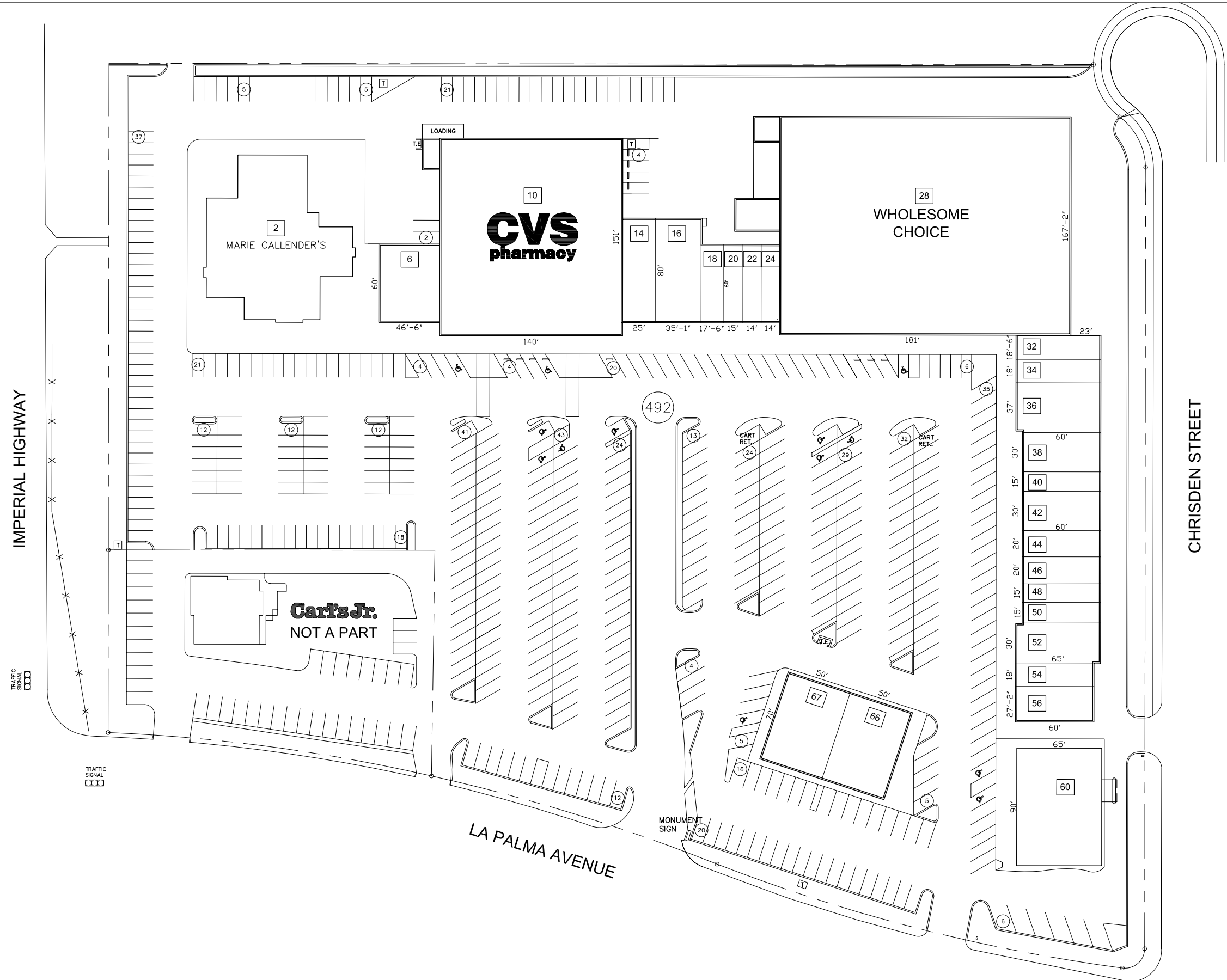

TOTAL BUILDING SF:	112,451 SF	(NOT INCL. CARL JR'S PARCEL)	
PARKING PROVIDED:	492 STALLS		
PARKING RATIO:	4.38/1000 SF	(NOT INCL. CARL JR'S PARCEL)	
TRAFFIC COUNTS:	23,400 ADT (2006)		
DEMOGRAPHICS	1 MILES	3 MILES	5 MILES
2007 EST. POP.	15,265	110,814	256,842
2012 PROJ. POP.	15,460	117,511	272,869
AVG. HH. INCOME	88,566	119,745	109,318



DISCLAIMER: THIS PLAN IS PROVIDED SUBJECT TO (i) ERRORS AND OMISSIONS IN THE INFORMATION AND (ii) MODIFICATION WITHOUT NOTICE. THE INFORMATION, SPECIFICATIONS, DIMENSIONS AND/OR TABULATIONS SET FORTH IN THIS PLAN HAVE BEEN DERIVED FROM DOCUMENTS BELIEVED TO BE RELIABLE. HOWEVER, THIS PLAN MAY BE INCOMPLETE AND/OR INACCURATE. NO REPRESENTATION OR WARRANTY, EXPRESSED OR IMPLIED AS TO THE ACCURACY OR ADEQUACY REGARDING SUCH INFORMATION IS MADE BY THE OWNER OF THE PROJECT, PROPERTY MANAGER OR ANY OTHER REPECTIVE PARTNERS, DIRECTORS, OFFICERS, EMPLOYEES AND AGENTS. NONE OF THE FOREGOING PARTIES SHALL HAVE ANY LIABILITY FOR SUCH ERRORS, OMMISIONS, INCOMPLETENESS OR INACCURACIES. ANY PERSON OR ENTITY REVIEWING THIS PLAN SHOULD MAKE THEIR OWN INDEPENDENT INVESTIGATION OF THE INFORMATION CONTAINED HEREIN.

CANYON VILLAGE PLAZA
 5711-6767 E LA PALMA AVENUE ANAHEIM, CA 92807
SITE LEASE PLAN

WATT COMPANIES
 2716 OCEAN PARK BOULEVARD
 SANTA MONICA, CA 90405
 T. 310.314.2430

SCALE: 0' 40' 80'
 Oct. 17, 09
 SHEET 1 OF 1