

# BALDEN TOWNE PLAZA

SEC VENTURA STREET & A STREET | FILLMORE, CALIFORNIA

## Available Space:

- 900sf
- 1,100sf
- 1,680sf
- 2,600sf
- 3,600sf

For leasing information,  
contact:

Tim Crissman  
tcrissman@crissmancommercial.com

Alan DiFatta  
alan@crissmancommercial.com



Crissman Commercial Services  
25031 West Ave. Stanford  
Suite 70  
Valencia, CA 91355  
661.295.9300  
661.295.0527 fax



## PROPERTY DETAILS:

- Strategically located along Highway 126, the major thoroughfare between Valencia and Ventura
- Anchored by Vons and Rite Aid

## DEMOGRAPHIC HIGHLIGHTS:

Estimates	1 Mile	3 Miles	5 Miles
Population	13,522	16,677	17,598
Average Household Income	\$70,891	\$73,549	\$74,571

Source: Claritas 2009

## TRAFFIC COUNTS:

Intersection	Cars Per Day
Ventura & A	63,000

Source: CalTrans, 2008

Owned and Managed by:



The information herein has been secured from sources we believe to be reliable; however, Watt Companies makes no guarantees, warranties or representations as to the completeness or accuracy thereof. The presentation of this property is submitted subject to errors, omissions, changes of price or conditions prior to the sale or lease, or withdrawal without notice.

# BALDEN TOWNE PLAZA

VENTURA STREET & A STREET | FILLMORE, CALIFORNIA

TENANT LEGEND		
SUITE	TENANT	SF
100	STARBUCKS	1500 sf
101	LITTLE CAESAR'S	1500 sf
102	AUTO ZONE	4020 sf
110	LAUNDERLAND	1920 sf
114	AVAILABLE	1660 sf
116	DIAMOND NAIL SALON	900 sf
118	RENNY'S SWEET HOME	1260 sf
122	A-1 DISCOUNT	1185 sf
200	VONS	41,425 sf
304	AVAILABLE	3600 sf
310	PAYLESS SHOES	3000 sf
316	RE/MAX	900 sf
318	WALT'S JEWELRY	900 sf
320	FILLMORE CLEANERS	1200 sf
400	RITE AID	20,122 sf
502	AVAILABLE	2600 sf
506	H & R BLOCK	990 sf
508	AVAILABLE	1100 sf
602	MOONLIGHT DONUTS	1085 sf
604	AVAILABLE	900 sf
606	BANK OF AMERICA ATM	900 sf
608	FILLMORE WATER STORE	900 sf
610	NEW CHINA WOK	900 sf
612	SUBWAY	1200 sf
700	BURGER KING	3110 sf
702	KFC	1700 sf

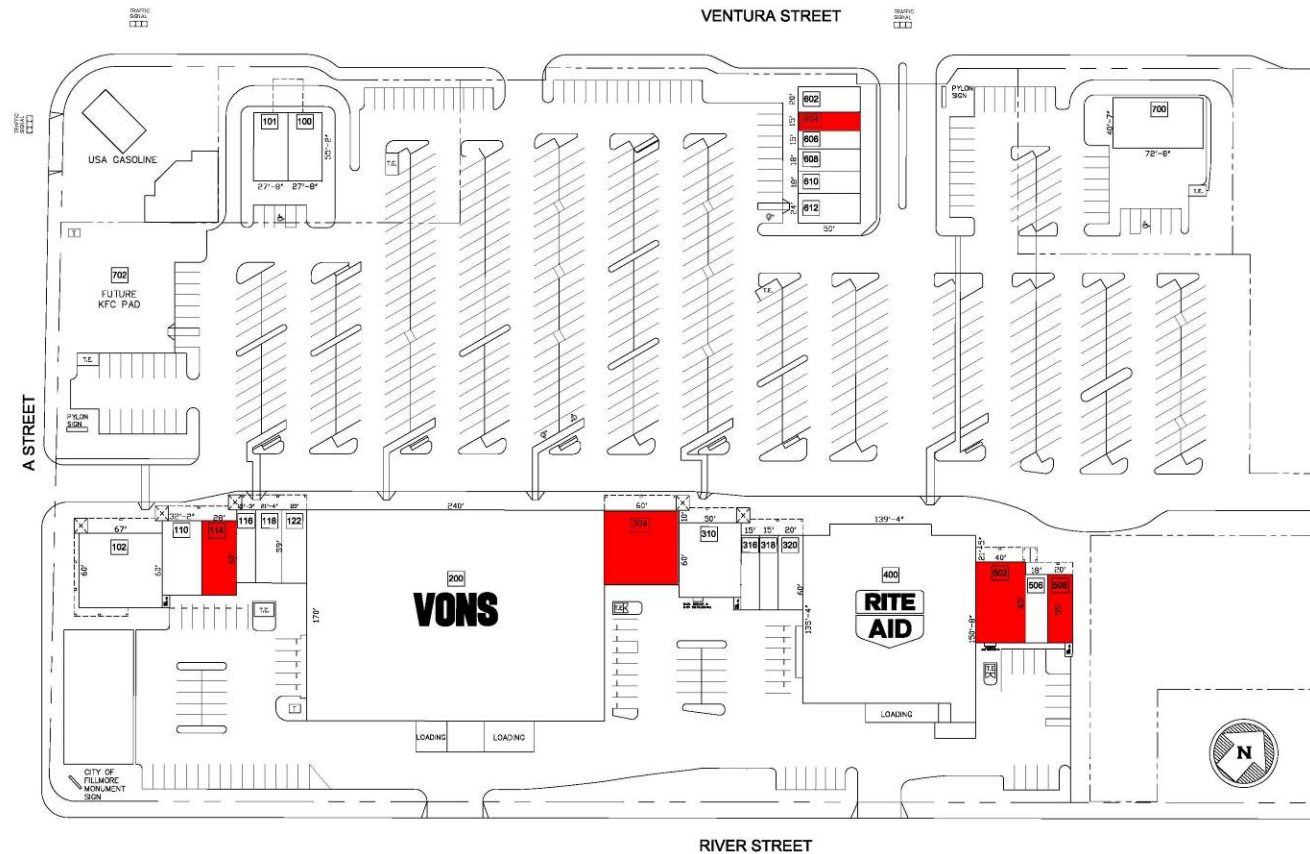

For leasing information,  
contact:

Tim Crissman  
tcrissman@crissmancommercial.com

Alan DiFatta  
alan@crissmancommercial.com



JOIN THESE RETAILERS:



Owned and Managed by:



Crissman Commercial Services  
25031 West Ave. Stanford  
Suite 70  
Valencia, CA 91355  
661.295.9300  
661.295.0527 fax

The information herein has been secured from sources we believe to be reliable; however, Watt Companies makes no guarantees, warranties or representations as to the completeness or accuracy thereof. The presentation of this property is submitted subject to errors, omissions, changes of price or conditions prior to the sale or lease, or withdrawal without notice.